

# TUPA Series

## Analytical Sensor Installation Fittings



### Features

- ✓ PVC | PP | PVDF Body
- ✓ Will Accept Signet® Type Analytical Sensors
- ✓ True-Union Design
- ✓ Excellent Chemical Resistance

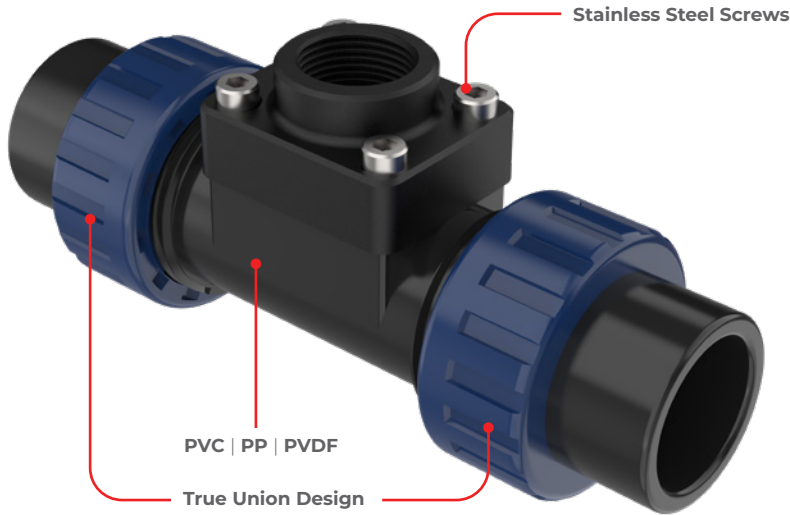

### Fittings and K-Factor

#### TEE FITTINGS



Tee Fitting		K-Factor		Sensor Length
IN	DN	LPM	GPM	
½"	15	268.0	1013.0	S
¾"	20	160.0	604.0	S
1"	25	108.0	408.0	S
1½"	40	37.0	140.0	S
2"	50	21.6	81.7	S
3"	80	9.3	35.0	S
4"	100	5.2	19.8	S

### Dimensions

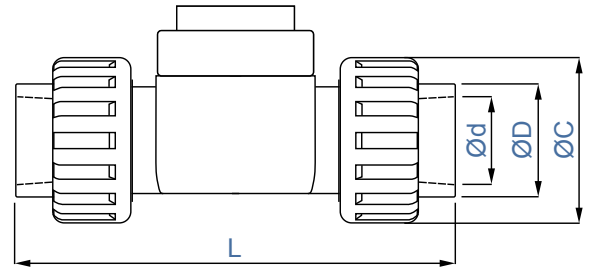

Pipe Size	L (inch)	d (inch)	D (inch)	C (inch)
½" DN (15)	5.48	0.84	1.07	1.61
¾" DN (20)	6.12	1.05	1.36	2.08
1" DN (25)	6.76	1.325	1.68	2.36
1½" DN (40)	7.66	1.91	2.33	3.26
2" DN (50)	8.39	2.38	2.86	4.33
3" DN (80)	8.92	3.00	4.60	7.56
4" DN (100)	9.40	3.90	5.81	9.00

### Model Selection

TUPA - PV - 020 - T - [ ] NOTE: Leave blank for standard options

Material	Pipe Size	End Connections	Seals
PV : PVC	005: ½"	S: Sch 80 Soc PVC (std)	FKM (std)
PP : PP	007: ¾"	T: NPT (Standard on PP/PVDF, available on PVC)	E: EPDM
PF : PVDF	010: 1"	F: ANSI 150lb Flange	
	015: 1½"	B: Butt Fusion (PP/PVDF)	

